

Warranty and Disclaimer

Farm Equipment Distributor Inc. (hereinafter called the "Company") and sellers of its digger machine warrant the machinery and parts of the product it manufactures to be free from defects in materials and workmanship for a period of ninety (90) days from the date of purchase when such product and parts of product are maintained and used in a customary and ordinary manner, and by competent personnel, who are aware of the care needed to handle this piece of machinery. No warranty is made by the Company either expressed or implied on products manufactured by others.

This warranty is the sole warranty and is in lieu of all other warranties, expressed or implied, including any implied warranty of merchantability or warranty of fitness for a particular purpose, or safety of use if not experienced in such use, and adequately clothed for such use.

The exclusive remedy for breach of this Warranty is repair or replacement of parts upon delivery, postage and freight prepaid to the company at 2896 State Route 232 Bethel, Ohio 45106, or refund of purchase price if repair or replacement cannot be provided. In no event shall the Company or the Sellers be liable for consequential or incidental damages, direct or indirect (including but not limited to loss of crops or livestock), due to defects in workmanship or defects in products manufactured by it. This is the only Warranty of the Company. The Company expressly disclaims all liability in tort or otherwise except as expressly provided for in this Warranty as set forth above.

This machine product must be carefully handled by a person who is familiar with its power structure, have no loose fitting garments on, or other obstacles near by when said machine is being operated, that the blades are always kept sharp, and be very careful in its use.

FARM EQUIPMENT DISTRIBUTORS INC.
PO BOX 54155
CINCINNATI, OHIO 45254-0155
513-734-1098

FARM EQUIPMENT
DISTRIBUTORS INC.

PO BOX 54155
CINCINNATI, OHIO 45254-0155
513-734-1098

POST HOLE DIGGER

OWNERS MANUAL AND SAFETY INSTRUCTIONS

FOR MODELS:

POST HOLE DIGGER WITH 6 INCH AUGER

POST HOLE DIGGER WITH 9 INCH AUGER

POST HOLE DIGGER WITH 12 INCH AUGER

POST HOLE DIGGER WITH 18 INCH AUGER

WARNING: READ THIS MANUAL COMPLETELY AND THOROUGHLY AND UNDERSTAND THE OPERATION OF A POST HOLE DIGGER BEFORE ATTEMPTING TO OPERATE THIS MACHINE. THIS MACHINE IS DESIGNED TO BE OPERATED BY ONLY ONE PERSON AND THAT PERSON SEATED IN THE TRACTOR SEAT.

FARM EQUIPMENT DISTRIBUTORS INC.
PO BOX 54155
CINCINNATI, OHIO 45254-0155
513-734-1098
OPERATING INSTRUCTIONS

THEN DISENGAGE PTO DRIVE. IF DIGGER ROTATES SMOOTHLY GO ON TO NEXT STEP, IF NOT REFER TO MOUNTING INSTRUCTIONS.

PLACE THE POINT OF THE AUGER AT THE DESIRED LOCATION OF THE FIRST HOLE. VERY SLOWLY PLACE POINT ON GROUND AND DRIVE THE TRACTOR BACKWARD OR FORWARD TO CREATE A 3 DEGREE ANGLE BACK OF CENTER OF THE GEAR BOX. AS THE AUGER WORKS INTO THE GROUND THE SLIGHT ANGLE WILL STRAIGHTEN DUE TO THE PIVOTING ACTION OF THE BOOM.

WITH THE AUGER POINT IN THE CORRECT POSITION AND ALL PERSONS 10 FOOT OR MORE FROM THE AUGER, ENGAGE THE PTO WITH THE TRACTOR AT A LITTLE MORE THAN AN IDLE SPEED. MOVE THE TRACTOR HYDRAULIC LIFT LEVER SLOWLY TO THE DOWN POSITION. ALLOW THE AUGER TO DIG UNTILL THERE IS AN INDICATION OF OVERLOADING. RAISE THE AUGER BUT DO NOT ALLOW THE AUGER TO COME COMPLETELY OUT OF THE HOLE. THIS ALLOWS THE AUGER TO CLEAN ITSELF OF LOOSE SOIL. LOWER THE AUGER INTO THE HOLE AND CONTINUE THIS PROCEDURE UNTILL THE DESIRED DEPTH IS REACHED.

CAUTION:

NEVER ENGAGE PTO WHEN AUGER POINT IS MORE THAT 10 INCHES ABOVE THE GROUND AS THIS COULD DAMAGE THE PTO OR THE DIGGER ITSELF.

IF AT ANY TIME THE AUGER FAILS TO DIG DISENGAGE PTO, TURN OFF TRACTOR AND REMOVE KEYS FOR THE IGNITION AND CHECK FOR THE FOLLOWING:

GRASS, ROOTS OR CLAY LODGED AROUND THE BLADES, FOREIGN OBJECTS SUCH AS WIRE WRAPPED ON BLADES OR POINT. CUTTING EDGES EXCESSIVELY WORN, GROUND TO DRY TO DIG (INSUFFICIENT GROUND MOISTURE), ROCKS BELOW SURFACE LEVEL

CLEAR ALL DEBRIS FROM AUGER, REPLACE WORN POINTS OR EDGES, DIG OUT ROCKS OR BREAK WITH SPUD BAR BY HAND, WAIT FOR MORE MOISTURE TO BE IN THE GROUND (RAIN)

DO NOT ATTEMPT TO ADD BODY WEIGHT TO INCREASE DOWN PRESSURE!

THIS DIGGER IS DESIGNED TO BE OPERATED BY ONLY ONE PERSON

TO AVOID DAMAGE TO UNIVERSAL JOINTS, DO NOT TRANSPORT DIGGER WITH TRACTOR PTO SHAFT ENGAGED.

FARM EQUIPMENT DISTRIBUTORS INC.
PO BOX 54155
CINCINNATI, OHIO 45254-0155
513-734-1098

OPERATORS RESPONSIBILITY

IT IS THE RESPONSIBILITY OF THE USER TO READ THE OPERATOR'S MANUAL AND UNDERSTAND THE SAFE AND CORRECT OPERATING PROCEDURES AS PERTAINS TO THE OPERATION OF THIS PRODUCT, AND TO LUBRICATE AND MAINTAIN THE PRODUCT ACCORDING TO THE MAINTENANCE SCHEDULE.

THE USER IS RESPONSIBLE FOR INSPECTING HIS MACHINE BEFORE USING, AND FOR HAVING PARTS REPAIRED OR REPLACED WHEN CONTINUED USE OF THE PRODUCT WOULD CAUSE DAMAGE OR EXCESSIVE WEAR TO OTHER PARTS. FURTHERMORE IT IS THE USERS RESPONSIBILITY TO ENSURE ALL SAFETY GUARDS ARE INSTALL CORRECTLLY AND ARE IN GOOD WORKING ORDER, MACHINES WITH GUARDS REMOVED AND OR IN DISTRESS ARE TO BE CONSIDERED "OUT OF SERVICE" UNTIL REPAIRES ARE MADE.

WARRANTY

THIS IMPLEMENT IS WARRANTED AGAINST DEFECTS IN MATERIALS AND WORKMANSHIP FOR A PERIOD OF 90 DAYS WHEN USED UNDER NORMAL OPERATING CONDITIONS FOR WHICH IT WAS DESIGNED.

SAFETY PRECAUTIONS

1. FLAGS OR OTHER WARNING DEVICES SHOULD BE USED ON CORNERS OF IMPLEMENT AND TRACTOR WHEN PARKED.
2. TO AVOID CATCHING ON VARIOUS TRACTOR AND IMPLEMENT PARTS LOOSE FITTING CLOTHING SHOULD NOT BE WORN.
3. MACHINERY SHOULD ONLY BE OPERATED BY THOSE WHO ARE RESPONSIBLE AUTHORIZED TO DO SO.
4. ONLY A QUALIFIED OPERATOR SHOULD BE PERMITTED ON TRACTOR WHEN IN OPERATION. NO RIDERS ALLOWED !!!
5. MAKE CERTAIN EVERYONE IS IN THE CLEAR BEFORE STARTING TRACTOR OR RAISING OR LOWERING IMPLEMENT.
6. OPERATE THE TRACTOR AND DIGGER ONLY WHILE SEATED IN THE TRACTOR SEAT.
7. STOP ENGINE, LOCK THE BRAKES AND REMOVE THE IGNITION KEY

FARM EQUIPMENT DISTRIBUTORS INC.
PO BOX 54155
CINCINNATI, OHIO 45254-0155
513-734-1098

- BEFORE DISMOUNTING THE TRACTOR FOR ANY REASON.
8. DO NOT OPERATE THE DIGGER IF PERSONS ARE WITHIN TEN (10) FEET OF THE MACHINE.
 9. REDUCE SPEED WHEN TRANSPORTING MOUNTED IMPLEMENTS TO AVOID BOUNCING AND MOMENTARY LOSS OF STEERING CONTROL
 10. NEVER STAND BETWEEN TRACTOR AND IMPLEMENT WHILE TRACTOR IS BEING BACKED TO HITCH UP THE IMPLEMENT.
 11. ALL DRIVE LINE SHIELDS AND GEAR BOX SAFETY SHIELDS MUST BE KEPT IN PLACE AT ALL TIMES. MISSING SHIELDING PUTS THE IMPLEMENT OR DRIVE LINE OUT OF SERVICE.
 12. INSPECT DIGGER BEFORE EACH USE FOR WORN OR BROKEN PARTS AND REPAIR BEFORE USING.

MOUNTING INSTRUCTIONS

BOLT YOKE TO BOOM IN CENTER HOLE WITH 3/4" X 5" BOLT/WASHER/NUT PROVIDED. INSTALL LONG LEG OF BOOM TO TRACTOR CENTER LINK MOUNTING BRACKET WITH CATEGORY 1 TOP LINK PIN AND CLIP. INSTALL YOKE TO TRACTOR LIFT ARMS WITH CATEGORY 1 PINS PROVIDED AND CLIPS. RAISE BOOM TO APPROPRIATE HEIGHT AND MOUNT GEAR BOX TO EARS OF BOOM WITH GEAR BOX PIN PROVIDED MAKING SURE SAFETY GUARD IS INSTALLED BETWEEN EARS OF GEAR BOX AND BOOM. MOUNT AUGER TO GEAR BOX WITH 1/2" X 3 1/2" GRADE 2 SHEAR BOLTS PROVIDED. MOUNT SPLINED END OF POWER TAKE OFF SHAFT (PTO) TO TRACTOR OUTPUT SHAFT BY DEPRESSING QUICK DISCONNECT BUTTON ON PTO AND SLIDING PTO ON SPINES OF TRACTOR OUTPUT SHAFT FAR ENOUGH TO ALLOW QUICK DISCONNECT BUTTON TO LOCK PTO TO TRACTOR OUTPUT SHAFT WHEN BUTTON IS RELEASED. MOUNT SMOOTH BORE END OF PTO TO IMPLEMENT GEAR BOX WITH 5/16" X 2 3/4" GRADE 2 SHEAR BOLT PROVIDED. TIGHTEN LOCKING SET SCREW (1/4" X 20 ALLEN SET SCREW) IN THE PTO TO LOCK PTO ONTO IMPLEMENT GEAR BOX. THIS SET SCREW LOCKS THE PTO TO THE IMPLEMENT GEAR BOX AND KEEPS THE PTO FROM COMING OFF IF THE SHEAR BOLT BREAKS UPON HITTING AN OBSTRUCTION. MAKE SURE ALL BOLTS ARE TIGHT, ALL SAFETY SHIELDS ARE IN WORKING ORDER AND THAT THE GEAR BOX HAS BEEN FILLED WITH SAE 90W GEAR OIL.

OPERATING INSTRUCTIONS

MAKE SURE NO PERSONS ARE WITHIN 10 FEET OF DIGGER BEFORE PROCEEDING. WITH THE DIGGER CORRECTLY ATTACHED TO THE TRACTOR, ENGAGE THE TRACTOR PTO AT IDLE SPEED TO GIVE THE UNIT A TEST RUN,

FARM EQUIPMENT DISTRIBUTORS INC.
PO BOX 54155
CINCINNATI, OHIO 45254-0155
513-734-1098

MAINTENANCE INSTRUCTIONS

IMPORTANT:

THE SHEAR BOLT HAS BEEN DESIGNED TO PROVIDE ADEQUATE PROTECTION FOR THE GEAR BOX AND DRIVE SHAFT (PTO). DO NOT REPLACE THIS BOLT WITH ANYTHING OTHER THAN THE RECOMMENDED BOLT OF THE SAME SIZE AND GRADE.

THE CORRECT SIZE AND GRADE OF BOLT IS:

5/16" X 2 3/4" GRADE 2 HEX HEAD BOLT/NUT

BEFORE USE OF MACHINE, THOROUGHLY INSPECT THE MACHINE TO BE SURE THAT ALL BOLTS, NUTS AND ANY OTHER FASTENED ASSEMBLIES HAVE BEEN THOROUGHLY TIGHTEN.

BEFORE USE OF MACHINE, BE SURE ALL SAFETY GUARDS AND LOCKING DEVICES ARE IN PLACE. (PTO SHIELD, GEAR BOX SHIELD, SHEAR BOLT SET SCREW, QUICK DISCONNECT COUPLER, LYNCH PINS, ECT.).

DO NOT OPERATE THIS POST HOLE DIGGER WITHOUT ALL SAFETY GUARDS AND LOCKING DEVICES IN PLACE AND IN WORKING ORDER.
MACHINES WITHOUT GUARDS ARE TO BE CONSIDERED OUT OF SERVICE

THE GEAR BOX IS LUBRICATED AT THE FACTORY WITH SAE 90 WEIGHT GEAR LUBE. ALWAYS USE SAE 90 WEIGHT GEAR LUBE OR ITS EQUIVALENT.

PERIODICALLY GREASE WITH ALL PURPOSE GREASE AT THE FITTINGS PROVIDED ON THE DRIVE SHAFT UNIVERSAL JOINTS AND SAFETY SHEILD.

TO ORDER REPLACEMENT PARTS CONTACT:

FARM EQUIPMENT DISTRIBUTOR INC.
PO BOX 54155
CINCINNATI, OHIO 45254-0155
513-734-1098 FAX 513-734-3536

OR CONTACT YOUR NEAREST FARM EQUIPMENT DEALER

FARM EQUIPMENT DISTRIBUTORS INC.
PO BOX 54155
CINCINNATI, OHIO 45254-0155
513-734-1098

QUANTITY	POSITION	DESCRIPTION
1	#1 PTO TO #4 GEAR BOX	SHEAR BOLT 5/16" X 2 3/4" GRADE 2 CAP HEX HEAD BOLT 1/4" SAFETY SET SCREW
1	SAFETY GUARD #2 BOOM TO #4 GEAR BOX INPUT	5/8" PIN WITH TWO (2) COTTER PINS
1	#2 BOOM TO #5 YOKE	3/4" X 5" HEX BOLT WITH LOCKWASHER AND NUT
2	#6 AUGER TO #4 GEAR BOX	1/2" X 3 1/2" HEX HEAD BOLT WITH NUT AND LOCKWASHER
4	CUTTINT EDGE TO #6 AUGER	3/8" X 1" CARRIAGE BOLT WITH LOCKNUT
1	SPIRAL TIP TO #6 AUGER	1/2" X 3" HEX HEAD BOLT WITH NUT AND LOCKWASHER
1	#1 PTO TO TRACTOR	SPRING LOADED QUICK DISCONNECT PIN
1	#2 BOOM TO TRACTOR	CAT #1 TOP LINK PIN (NOT PROVIDED)
2	#5 YOKE TO TRACTOR	CAT #1 LIFT ARM PIN
2	# 3 SAFETY GUARD TO #4 1/4" X 3/4" HEX HEAD BOLT GEAR BOX OUTPUT	

FARM EQUIPMENT DISTRIBUTORS INC.
PO BOX 54155
CINCINNATI, OHIO 45254-0155
513-734-1098

SPARE PARTS LIST

POSITION PEICES	DESCRIPTION
1 1	POWER TAKE OFF (PTO)
2 1	BOOM ASSEMBLY
3 1	SAFETY GUARD (GEAR BOX / PTO) SAFETY GUARD (GEAR BOX / AUGER)
4 1	GEAR BOX
5 1	YOKE ASSEMBLY
6 1	AUGER ASSEMBLY
6A	6" AUGER ASSEMBLY CONSISTING OF: 1 6" AUGER 2 6" CUTTING EDGES 1 SPIRAL POINT 4 CARRIAGE BOLT/NUT FOR CUTTING EDGES 1 BOLT/WASHER/NUT FOR SPIRAL POINT
6B	9" AUGER ASSEMBLY CONSISTING OF: 1 9" AUGER 2 9" CUTTING EDGES 1 SPIRAL POINT 4 CARRIAGE BOLT/NUT FOR CUTTING EDGES 1 BOLT/WASHER/NUT FOR SPIRAL POINT
6C	12" AUGER ASSEMBLY CONSISTING OF: 1 12" AUGER 2 12" CUTTING EDGES 1 SPIRAL POINT 4 CARRIAGE BOLT/NUT FOR CUTTING EDGES 1 BOLT/WASHER/NUT FOR SPIRAL POINT
6D	18" AUGER ASSEMBLY CONSISTING OF: 1 18" AUGER 4 18" CUTTING EDGES 1 SPIRAL POINT 8 CARRIAGE BOLT/NUT FOR CUTTING EDGES 1 BOLT/WASHER/NUT FOR SPIRAL POINT

LABEL "H"

 **WARNING**

DO NOT OPERATE
WITH GUARDS REMOVED

COULD RESULT
IN BODILY
INJURY



10-20

LABEL "I"

 **WARNING**

UNIT IS OUT OF SERVICE
GUARDS ARE REMOVED

 **WARNING**

FED5

! DANGER



**ROTATING DRIVELINE
CONTACT CAN CAUSE DEATH
KEEP AWAY!
DO NOT OPERATE WITHOUT-**

- ALL DRIVELINE GUARDS, TRACTOR AND EQUIPMENT SHIELDS IN PLACE
- DRIVELINES SECURELY ATTACHED AT BOTH ENDS
- DRIVELINE GUARDS THAT TURN FREELY ON DRIVELINE

eurocardan s.p.a.
66041 ATESSA (CH) - Italy

LABEL "D"

! DANGER

**THIS DIGGER MACHINE IS
DANGEROUS. OPERATE AT YOUR
OWN RISK.
WE DO NOT GUARANTEE
ITS SAFETY**

FED1

LABEL "A"

! DANGER

MOVING AUGER



SERIOUS PERSONAL INJURY MAY RESULT IF ANY ATTEMPT IS MADE TO ASSIST DIGGER OPERATION BY HAND. KEEP CLOTHING, YOURSELF, AND OTHERS WELL CLEAR OF MOVING AUGER AND ROTATING PTO SHAFT. ALL SHIELDING TO BE KEPT IN PLACE DURING OPERATION. PTO OPERATING SPEED-540 RPM

FARM EQUIPMENT DISTRIBUTORS, INC.
P.O. BOX 54155
CINCINNATI, OH 45254-0155 FED3

LABEL "F"

**FARM EQUIPMENT
DISTRIBUTORS, INC.**

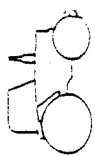
P.O. BOX 54155 • CINCINNATI, OH 45254-0155 • TEL 513-734-1099

EUROCARDAN

NOZIONI DI FUNZIONAMENTO E MANUTENZIONE:

- PROTEGGERE CON SCHERMO FISSO IL GIUNTO CARDANICO IN MOVIMENTO
- COLLEGARE CORRETTAMENTE IL GIUNTO ALLA PRESA DI FORZA DEL TRATTORE ED ALLA MACCHINA OPERANTE.
- ALLACCIARE LE CATENE DEL GIUNTO AL TRATTORE.
- INGRASSARE IL GIUNTO NEI PUNTI INDICATI.

NOTIONS OF FUNCTIONING AND MAINTENANCE:

- PROTECT THE MOVING CARDAN JOINT WITH A FIXED GUARD.
- FASTEN CORRECTLY THE JOINTS TO THE P.T.O. SHAFT OF THE TRACTOR AND OF THE OPERATING MACHINE.
- FASTEN THE CHAINS OF THE JOINTS TO THE TRACTOR.
- GREASE THE JOINT IN THE INDICATED POINTS.

INSTRUCTIONS DE FONCTIONNEMENT ET ENTRETIEN:

- PROTÉGER PAR UN ÉCRAN FIXE LE JOINT EN MOVEMENT.
- COUPLER CORRECTEMENT LE JOINT À LA PRISE DE FORCE DU TRACTEUR ET À LA MACHINE.
- ATTACHER LES CHAINES DU JOINT AU TRACTEUR.
- GRAISSER LES POINTS INDICUES DU JOINT.



DANGER

- STARE LONTANI DAL GIUNTO DURANTE LA FUNZIONE. PERICOLO DI MORTE.
- KEEP AWAY FROM THE JOINT DURING THE FUNCTION. DANGER OF DEATH.
- ÉVITER DE S'APPROCHER DU JOINT DURANT LE FONCTIONNEMENT. DANGER DE MORT.



GREASE

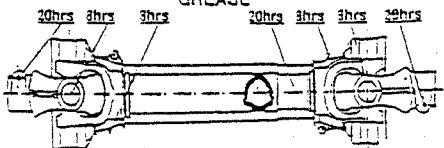

MADE IN ITALY eurocardan s.r.l.

IT IS UP TO YOU

SAFETY FIRST

Better to be SAFE than SORRY

Don't find out the hard way that careless actions can make you, your family, your friends, or an innocent by-stander the victim of an accident. Safety is an everyday need. Outfit yourself with a complete safety program.

Read your Operator's Manual thoroughly; know how to operate your machine properly and safely. Always take the necessary safety precautions.



THINK BEFORE YOU ACT



Note: * refers to a label, i.e., *A refers to LABEL A

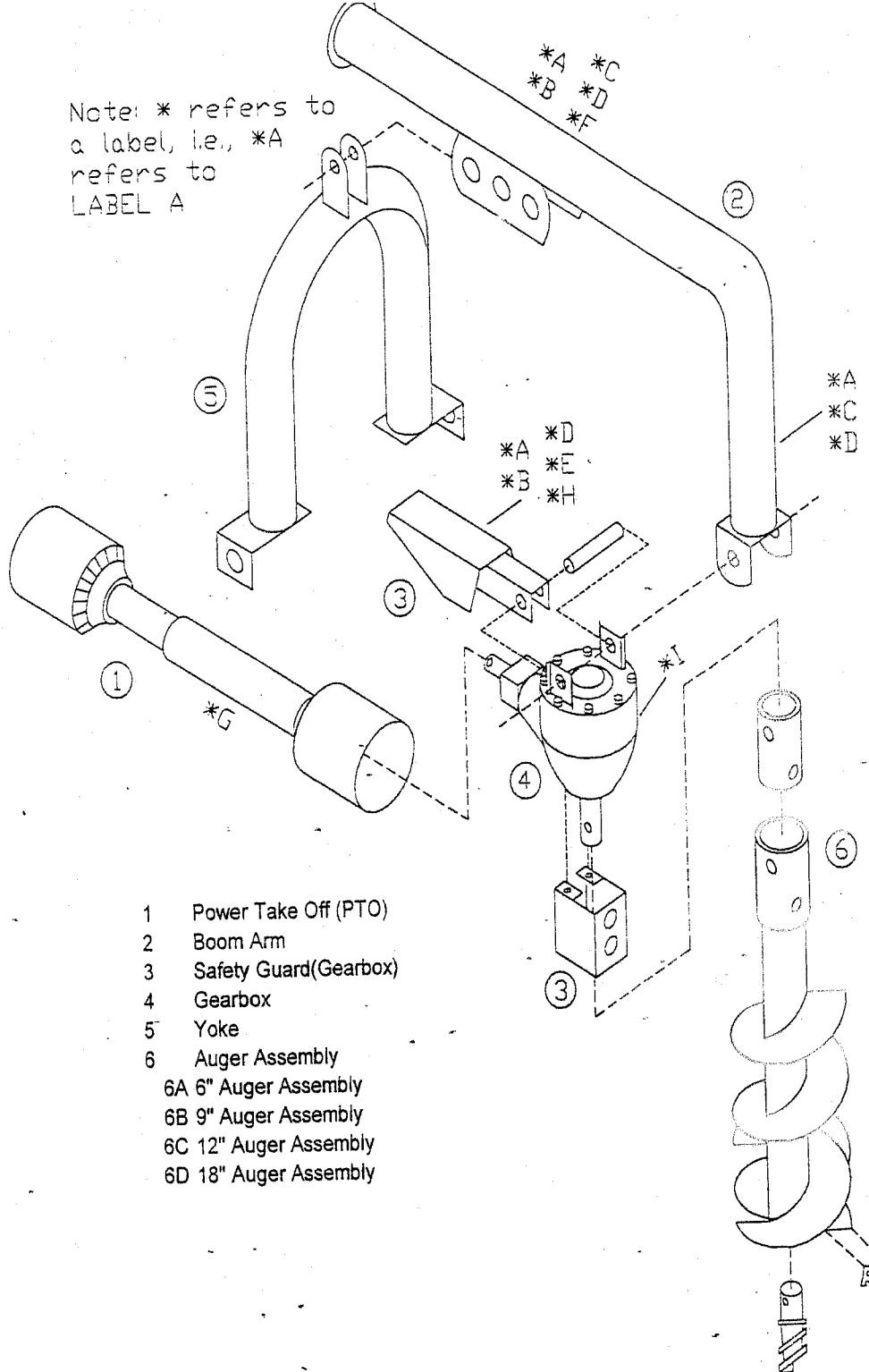

- 1 Power Take Off (PTO)
- 2 Boom Arm
- 3 Safety Guard(Gearbox)
- 4 Gearbox
- 5 Yoke
- 6 Auger Assembly
- 6A 6" Auger Assembly
- 6B 9" Auger Assembly
- 6C 12" Auger Assembly
- 6D 18" Auger Assembly

IMPORTANT SAFETY MESSAGE FOR OWNERS/OPERATORS OF POST HOLE DIGGERS

Safety is a primary concern in the design, manufacture, sale, and use of post hole diggers. As manufacturers of post hole diggers, we want to confirm to you, our customers, our concern for safety. We also want to remind you about the simple, basic, and common sense rules of safety when using a post-hole digger. Failure to follow these rules can result in severe injury or death to operators or bystanders.

It is essential to everyone involved in the assembly, operation, maintenance, and storage to this equipment be aware, concerned, prudent, and properly trained in safety. The majority of accidents involve entanglement on the driveline or auger. This entanglement risk becomes greater when you replace our shear bolts with bolts longer than those specified by the manufacturer. This improper replacement occurs most often on machines that are loaned or rented to someone who has not read the owners manual and is not familiar with a post-hole digger.

Our current production machines include, as standard equipment, guards or shields for auger adapters, drivelines, input shafts, and safety signs. Older machines can be retrofitted to add these new current standards safety equipment, please contact your dealer about bringing your machine up to the current level of safety.

Below are some of the most important safety rules to be understood and followed by anyone who works with post-hole diggers:

- Before operating a post-hole digger, an operator must read and understand all the information in the owner's manual and in the safety signs attached to the product. A person who has not read or understood the owner's manual and safety signs is not qualified to operate the digger. If you do not have an owner's manual or current protective safety signs, contact the manufacturer or your dealer immediately!
- Post-hole diggers are designed for one-man operation. You must always dig holes while sitting in the tractor seat. Never operate the digger with anyone near, or in contact with, any part of the implement, PTO driveline, or auger. Accidents have occurred when more than one person is in the immediate area of the operating equipment. Be sure no one else, including bystanders, is near you when you operate this product.
- Do not operate the digger unless all shields and guards are in place.
- Never replace the shear bolt or auger retaining bolt with one longer than those supplied and specified by the manufacturer. See your owner's manual.
- Do not use the digger unless the auger point and cutting edges are intact and in good working order.

Following these simple, basic safety rules, as well as others identified in the owner's manual and in product safety signs, will help minimize the possibility of accidents and increase your productivity in using this product. Be careful and make sure that everyone who operates the digger knows and understands that it is a very powerful piece of machinery, and if used improperly, serious injury or death may result. The final responsibility for safety rests with the operator of this machine.

This SAFETY MESSAGE is brought to you by the following manufacturing companies: ALAMO GROUP, SEFCO INC., BELLTEC INDUSTRIES, BUSH HOG, DANUSER MACHINE CO., DEERE & CO., FORD NEW HOLLAND, GREEN MANUFACTURING INC., HOWSE IMPLEMENT, KUBOTO TRACTOR, LOWE MANUFACTURING CO., MCMILLEN, MELROE CO., MODERN MANUFACTURING, SHAVER MANUFACTURING, SMC CORP., SPEEDCO, VASSAR MANUFACTURING, AND WORKSAVER.