

IM Series rotary cutter
Parts manual

IM - 400
IM - 500 / 502
IM - 600 - 602
IM - 702

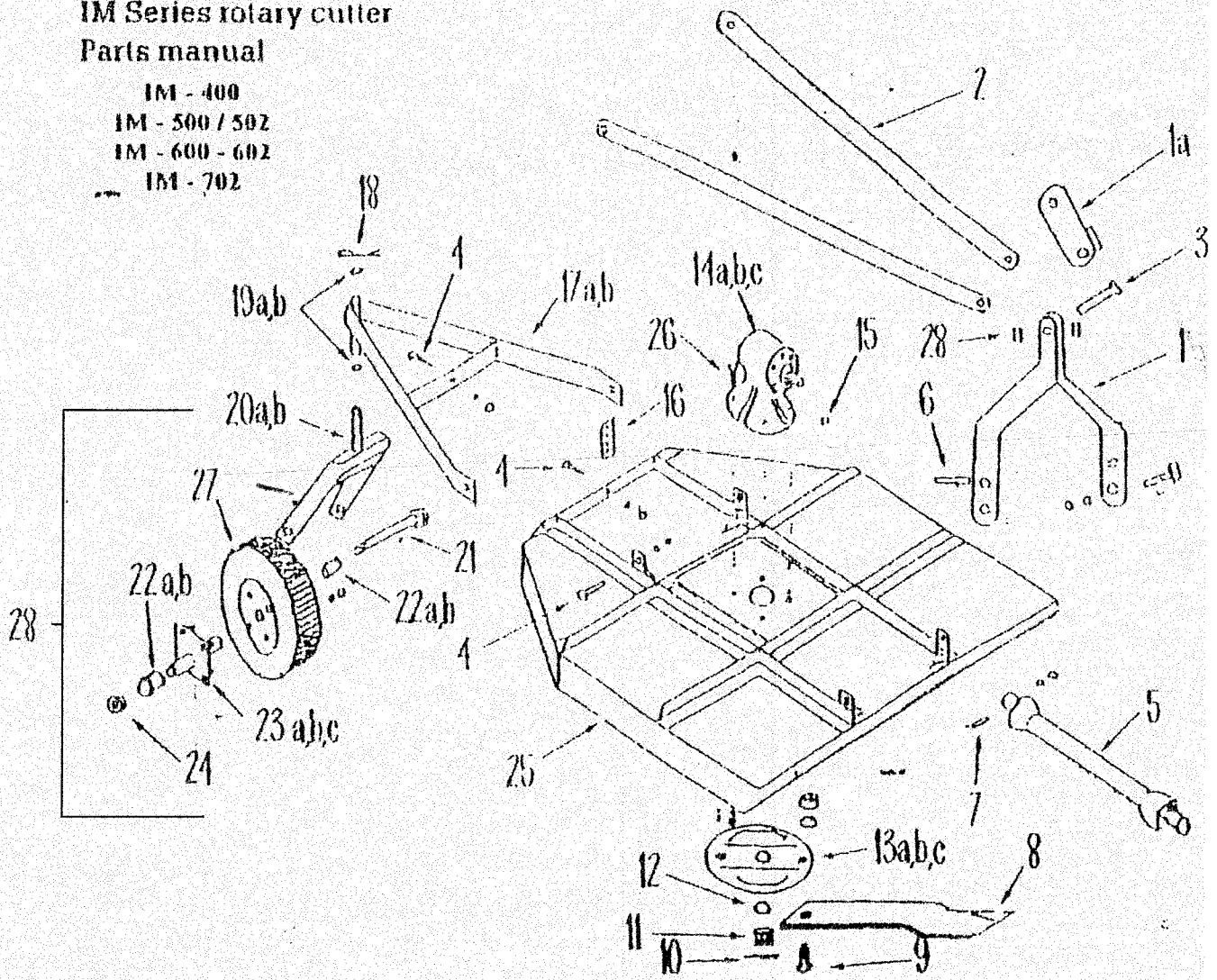

Rotary Cutter Spare Parts List

<u>Position</u>	<u>Part #</u>	<u>Description</u>
1A	CHE-WACRCAF-H	3-pt. A-Frame Heavy (IM600-IM702)
1B	CHE-WACRCAF-L	3-pt. A-Frame Light (IM380-IM500)
2A	CHE-WAC-RCBB5	Brace Bar (IM500)
2B	CHE-WAC-RCBB6	Brace Bar (IM600-IM602)
2C	CHE-WAC-RCBB7	Brace Bar (IM702)
3		Brace Bar Bolt/Nut/Lockwasher 5/8 x 4.5
4		A-Frame Mounting Bolt/Nut/Washer 3/4" x 16 x 2
5A	TX4-740	Drive Shaft (PTO) (IM500 Shearpin)
5B	TX4-790 -FD2	Drive Shaft (PTO) (IM502 with slip clutch)
5C	TX4-890	Drive Shaft (PTO) (IM600 Shearpin)
5D	TX4-840-FD2	Drive Shaft (PTO) (IM602 with slip clutch)
5E	TX5-IM702	Drive Shaft (PTO) (IM702)
6		Lift Arm Pin
7		Shear Bolt 1/2 x 3.5 Grade 2 (soft)
8A	IM4	Blade (IM400)
8B	IM5	Blade (IM500-502)
8C	IM6	Blade (IM600-602)
8D	IM6HD	Blade (IM602 HD)
8E	WAC23	Blade (IM600-IM702) (4" wide)
9A	BB62	Blade Bolt
9B	JN118	Jam Nut for Blade Bolt
9C	LW118	Lockwasher for Blade Bolt
10		Flywheel Cotter Pin
11	CHE-11-008	Castle Nut (Output shaft)
12		Flat Washer
13A	CHE-WACFW-40-11.5	Flywheel- 11.5" Bolt Hole Spacing 40HP (1.57" 12-spline Hub)
13B	CHE-WACFW-40-14	Flywheel- 14" Bolt Hole Spacing 40HP (1.57" 12-spline Hub)
13C	CHE-WACFW-75-11.5	Flywheel- 11.5" Bolt Hole Spacing 75HP (1.97" 15-spline Hub)
13D	CHE-WACFW-75-14	Flywheel- 14" Bolt Hole Spacing 75HP (1.97" 15-spline Hub)
14A	01-008	Gear Box- 40 HP with Shear Bolt (smooth input), 12-spline output
14B	CHE-01-004	Gear Box- 40 HP 6-spline input shaft, 12-spline output shaft
14C	CHE-250372	Gear Box- 75 HP 6-spline input, 15-spline output
14D	CHE-01-268	Gear Box- 105 HP- 20-spline input, 15-spline output
15		Snap Ring 40 HP Shear Bolt Only
16		Tailwheel Height Plate
17	CHE-RC16	Tailwheel A-Frame
18	CHE-16-102D	Tailwheel Cotter Pin
19		Tailwheel Fork Washers
20A	CHE-RC-007	Tailwheel Fork- (1986-2006) 1-1/2" post
20B	CHE-16-098	Tailwheel Fork- (2006-Current) 1-1/4" post
21	CHE-RC-001	Axle Bolt- 1" x 9"
22	CHE-1-G/B	Graphoil Bushing
23A	CHE-RCFABHUB	Fabricated Hub, 4-bolt, Standard Duty
23B	CHE-16-097C	Heavy Duty Bushing type hub (IM600-702)
24		Nut for axle bolt (1" castle nut)
25		Main Body
26		Gear Box Mounting Bolts
27A	CHE-4x8	ailwheel 15" with rim (no hub)
27B	CHE-6x9-4lug	Tailwheel 21" with 4-lug rim
27C	CHE-6x9-5lug	Tailwheel 21" with 5-lug rim
28A	CHE-16-102-Bush	Complete Tailwheel Assy. 1-1/2" post, bushing type hub
28B	CHE-16-102	Complete Tailwheel Assy. 1-1/2" post, tapered bearing hub
28C	CHE-16-097	Complete Tailwheel Assy. 1-1/4" post

AP

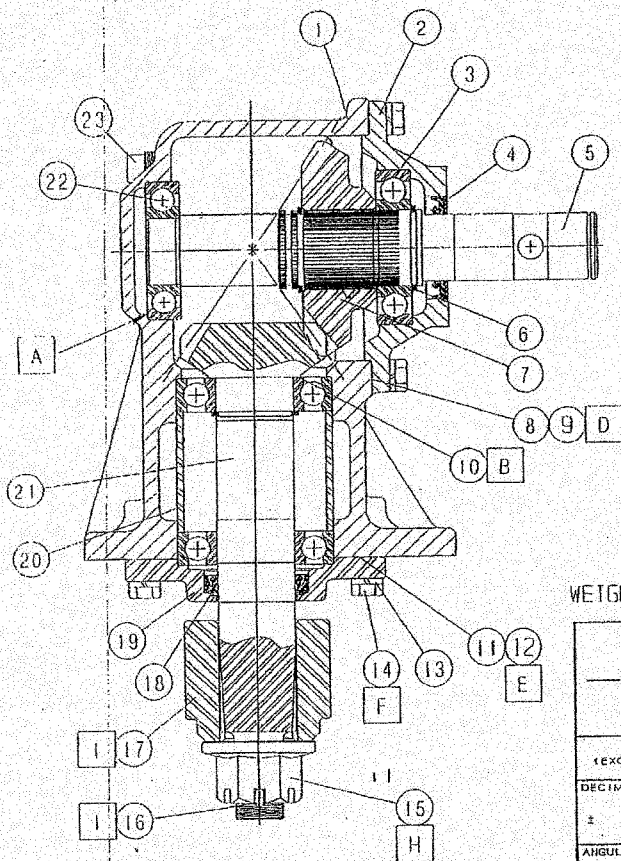

RATED 40 HP AT 540 RPM

WEIGHT: 51.8 LBS.

REV	DATE	REVISION RECORD	REF
5	10/5/94	FLANGE NUT #11-008 WAS #11-007 AND WASHER #07-007 ADDED I.D. TAG #13-004 AND I.D. TAG RIVET #12-021	

26	13-004	1	I.D. TAG
25	12-021	2	I.D. TAG RIVET
24	09-005	1	1/8" LEVEL PLUG
23	09-002	1	1/2" OIL FILL PLUG
22	04-004	1	BALL BEARING 207
21	03-002	1	15 TOOTH OUTPUT SFT & PINION
20	10-002	1	OUTPUT BEARING SPACER
19	20-003	1	OUTPUT CAP
18	05-005	1	OUTPUT SEAL
17	15-001	1	BLADE HUB
16	12-003	1	COTTER PIN
15	11-008	1	1"-14 SLOTTED FLANGE HEX NUT
14	08-008	10	3/8"-16 X 1" CAP SCREW
13	07-001	10	Ø10 LOCKWASHER
12	08-005B	VAR	OUTPUT GASKET (0.13)
11	08-005A	VAR	OUTPUT GASKET (0.30)
10	17-004	1	STEEL SHIM (0.20)
9	08-004B	VAR	INPUT GASKET (0.13)
8	08-004A	VAR	INPUT GASKET (0.30)
7	03-001	1	22 TOOTH INPUT GEAR
6	21-012	3	RETAINING RING
5	02-010	1	INPUT SHAFT
4	05-002	1	INPUT SEAL
3	04-003	3	BALL BEARING 208
2	20-007	1	INPUT CAP
1	18-010	1	HOUSING

		INTERNATIONAL TECHNOLOGY GROUP		ENG. OFFICE: P.O. BOX 1658 DODGE CITY, KS 67801 (316) 227-2463
TOLERANCES (EXCEPT AS NOTED):		REFERENCE NUMBER	SCALE 3/8" = 1"	SALES OFFICE: 5841 EDISON PLACE SUITE 110 CARLSBAD, CA 92008 (619) 431-3644
DECIMAL ±	FRACTIONAL ±	TITLE ITG 30-1:1.47 S.U. - 1 3/8" - 1/2" SHEAR BOLT		DRAWN BY G.J.K.
ANGULAR ±	MACHINE FINISH <input checked="" type="checkbox"/>	DATE 10/5/94	PART NUMBER 01-008	APPROVED BY
			REVISION 5	